



**211 Croudace Street NEW LAMBTON HEIGHTS NSW**

3 1 1

Rich in memories with a nostalgic charm in the same family for nigh on 60 years. Covered entry porch opens to the hallway with 3 bedrooms(2 with built in wardrobes) formal lounge room with original fireplace and air conditioner interconnects to the formal dining room, with a large country style kitchen with servery window to generous rear family room with picture windows on two sides overlooking Blackbutt Reserve. The central bathroom features original terrazzo floor with black border, a shower recess and separate bath. Wide cornices, timber floors .Laundry store room/workshop under and carport. A great block APPROX 695 SQ metres with a 15M frontage.

**Type** : House  
**Land Size** : 695 sqm  
**View** : <https://www.crawfordrealestate.com.au/sale/nsw/newcastle-region/new-lambton-heights/residential/house/5660428>



**Margaret Jensen**  
 02 4957 6166

CLOSE TO JOHN HUNTER HOSPITAL.  
[For full version visit the website](#)

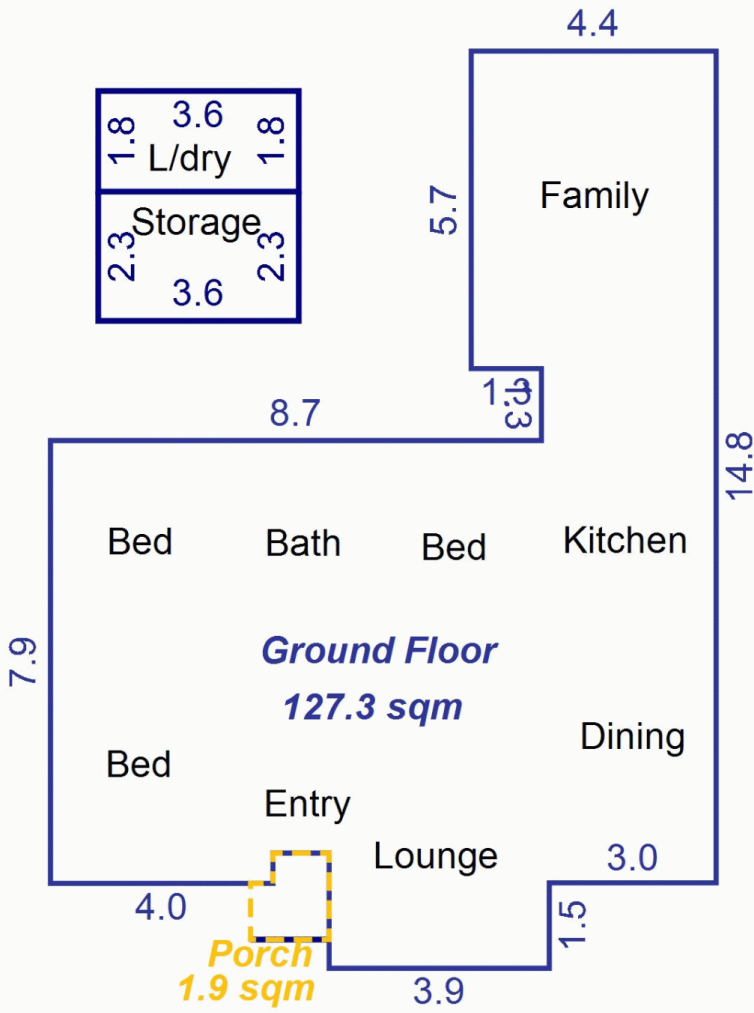

Building  
Internal

