



270 Newcastle Road North Lambton NSW

3 **1**

This entry level property situated on a large block of approx. 828m² with a wide frontage offers many opportunities for the savvy purchaser.

Set down from the road with off street parking for up to 3 cars and screened by a high front fence this quaint property offers:

- 2/3 bedrooms main with built-in robe & ceiling fans to both beds
- Lounge room or 3 bedroom offers RC air conditioning and overlooks the private front garden
- Central bathroom with fresh white and blue colour palette
- The kitchen features gas cooktop & electric oven with dining nook and RC air conditioning
- Flowing from the kitchen is a fabulous large north facing covered rear deck overlooking the large backyard, ideal for kids or pets to play.
- Underneath the home is a large, concreted area, suitable for storage of bikes, tools, equipment or any number of uses.

This convenient location has access to public transport, the

Price : \$ 615,000
Land Size : 828 sqm
View : <https://www.crawfordrealestate.com.au/sale/nsw/newcastle-region/north-lambton/residential/house/7177800>



Amanda Swan
02 4957 6166



Phillip Swan
4957 6166

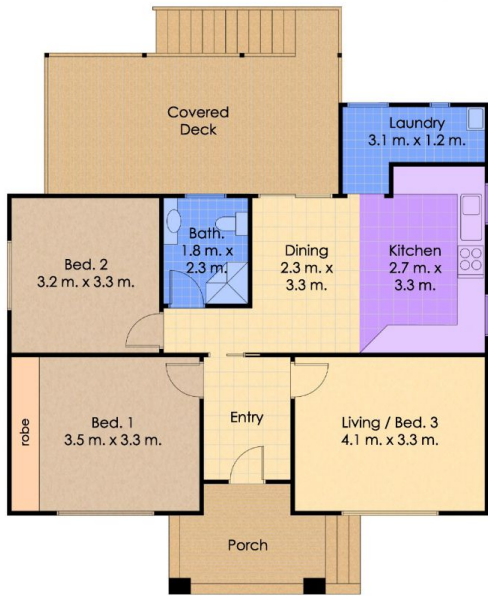

Upper Floor Plan
Total Approx. Internal Floor Area: 83 sqm

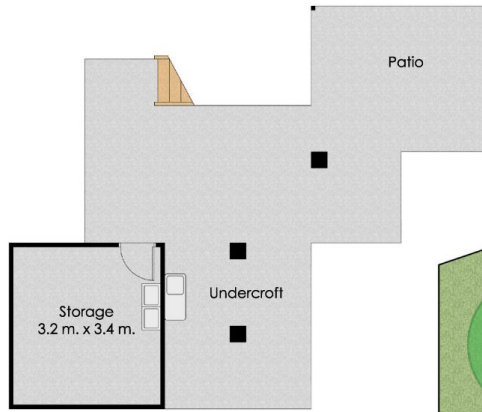

Lower Floor Plan



Site Plan
Not to Scale



270 Newcastle Rd
North Lambton

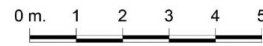

Measurements and direction of north are approximate and are to be used as a guide only.