



4/111 Hobart Road New Lambton NSW

3 1 1

A most appealing Brick Veneer & Tile Townhouse in a boutique block of 5 built circa 1992.

ACCOMMODATION comprises Tiled entry to spacious flowing open plan living & dining featuring Laminated Floating floors, a modern kitchen with gas cook top & oven, & Breakfast bar, sliding doors to sunny paved rear courtyard & timber deck. Internal access from single LUG with auto door. Tiled laundry and a 2nd WC.

UPSTAIRS: 3 BEDROOMS, generous main with mirrored built-in robes, modern bathroom with Period influence has corner shower & bath tub, separate WC, double linen cupboard.

FEATURES include air conditioner in lounge room + gas bayonet for heater, Classic turned timber staircase, fresh decor with universal appeal, covered front porch.

Enjoy the Village lifestyle & amenities - close to Lambton Park & Pool complex, sporting facilities and the cafe culture of New Lambton & Lambton.

View : <https://www.crawfordrealestate.com.au/lease/nsw/newcastle-region/new-lambton/residential/townhouse/7271837>



Kerry Robertson
02 4957 6166

Lower Level

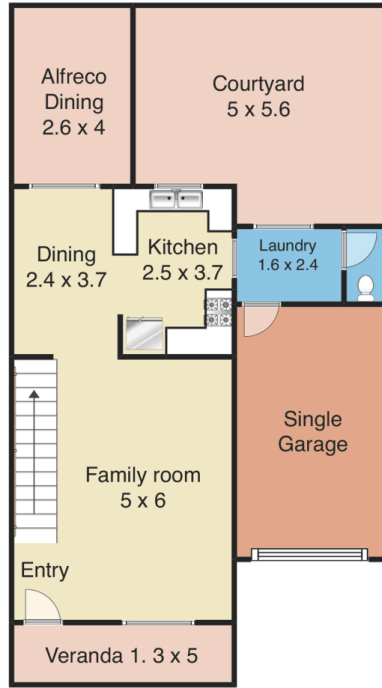

Upper level

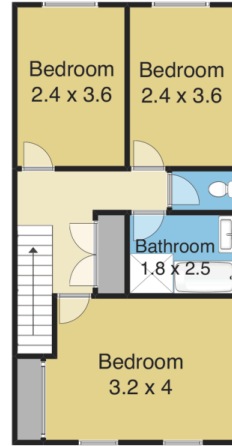

4/111 Hobart Road, New Lambton

Measurements are approximate and are to be used only as a guide

