



4/26 Railway Road New Lambton NSW

1 1 1

This neat and tidy 1 bedroom ground floor apartment is the perfect opportunity for a first home buyer to step into the market or investor to add to their portfolio.

Price : \$ 425,500

View : <https://www.crawfordrealestate.com.au/sale/nsw/newcastle-region/new-lambton/residential/unit/7439169>

With open plan living and a good size bedroom with built in wardrobe, it's great position in between New Lambton and Lambton Villages- you will not be disappointed!

The Single lock up garage is the perfect spot to hide away your car and toys!

Only 550metres from Lambton Swimming Pool, 3.3kms from John Hunter Hospital and public transport close by, you will need to get in quick to make it yours!



Phillip Swan
4957 6166



Sarah Andrews
0432 179 448

Zoned for the very much sought after New Lambton Public School for Years K - 6 and Lambton High School for years 7-12.

Council Rates: \$1412.00 approx pa.

Water Rates: \$687.00 approx pa.

Strata Rates: \$2348.00 approx pa.

Potential Rent: \$350 pw.

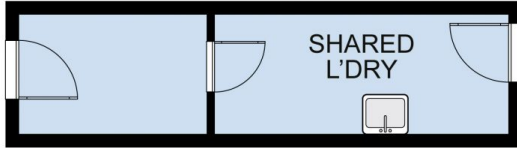

(Not in position)

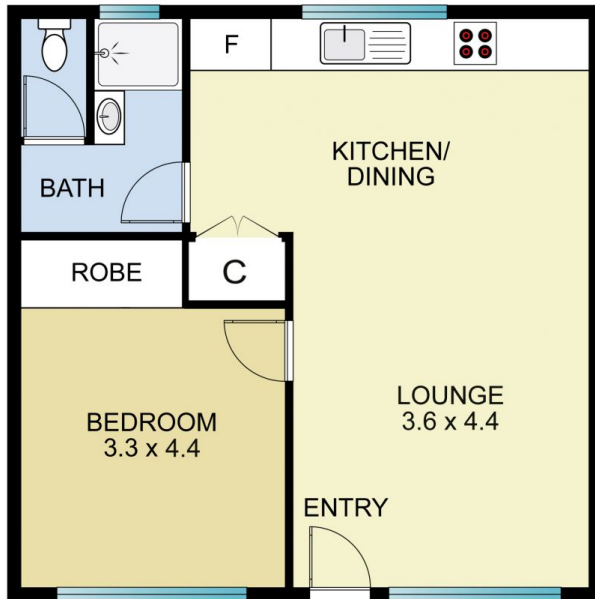

Internal 45m² approx

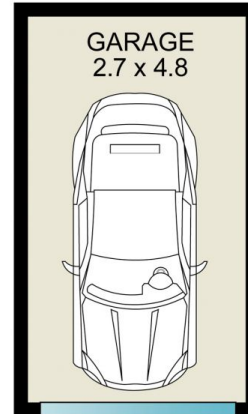

(Not in position)

4/26 RAILWAY ST NEW LAMBTON

All measurements are indicative and shown in metres. It is not an exact replica of the property internally or externally.
Interested parties should not rely wholly on these plans and make their own enquiries.