



## 7 Isabella Close Elermore Vale NSW

4 🚗 2 🚗 2 🚗

For those who think outside the square & appreciate quality this generously proportioned custom designed & built Brick & tile home is sure to impress.

Set back on a large 955sqm block with a sweeping arc frontage the impressive façade has a resort style influence. The home is built across the block with a large 6.3m x 7m garage and extensive sub floor storage facilities under with internal stairs to the main living area.

A stunning feature is the soaring raked ceilings & exposed brick feature walls which create an instant "wow" factor to compliment the generous multiple living zones strategically positioned around the centrally located kitchen. Each living space opens to the outdoors with access at the front to maximise the benefit of the sunny northerly aspect overlooking the swimming pool. A large arched servery from the kitchen connects to the rear living zones incorporating a wet bar for those who like to entertain.

The main entry foyer features a convenient cloak cupboard & access to the powder room which has been cleverly designed to connect to the en-suite bathroom servicing the oversized ground floor Master bedroom with a walk-in wardrobe plus mirrored robe.

UPSTAIRS provides 3 additional family bedrooms all with

**View** : <https://www.crawfordrealestate.com.au/sale/nsw/newcastle-region/elermore-vale/residential/house/7516931>



**Margaret Jensen**  
02 4957 6166



**Site Plan**

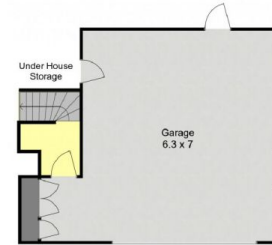

**Lower Level**

**7 Isabella Close,  
Elermore Vale**



Measurements are approximate and are to be used as a guide only

