



**CRAWFORD**  
REAL ESTATE



**CRAWFORD**  
REAL ESTATE



**CRAWFORD**  
REAL ESTATE



**CRAWFORD**  
REAL ESTATE

**10B Whalan Street Garden Suburb NSW**

5 🏠 2 🚗 2 🚗

If it is privacy, peace and quiet you are looking for then this is the home for you. This stylish brick home on a battleaxe block has been freshly styled to suit the growing family.

Be greeted by a sunny formal entry which opens to a large combined living and dining space complete with split system air conditioning for year round comfort.

The adjoining modern kitchen has been finished with walk in pantry, dishwasher, electric stove top, wall oven and ample cupboard space, as well as breakfast bar which is perfect for entertaining whilst cooking dinner.

Four generously sized bedrooms, the master with ensuite, built in robe and its own a/c unit. Additionally a 5th bedroom that would be perfect for those studying or working from home.

Downstairs offers rumpus room or teenage play area, plenty of understairs storage, a family bathroom and internal laundry.

Highlights of this spacious property:

**Price** : \$ 955,000  
**Land Size** : 620 sqm  
**View** : <https://www.crawfordrealestate.com.au/sale/nsw/newcastle-region/garden-suburb/residential/house/7564611>



**Phillip Swan**  
4957 6166



**Amanda Swan**  
02 4957 6166



GROUND FLOOR

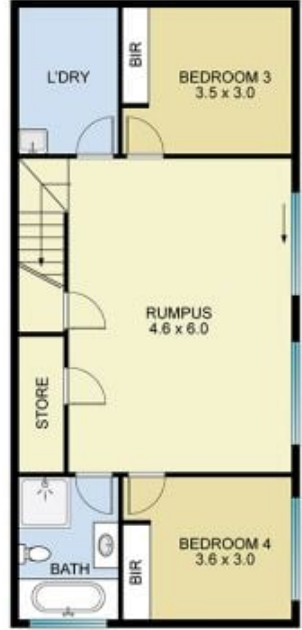

LOWER GROUND FLOOR

Internal 182m<sup>2</sup> approx



10B WHALAN ST GARDEN SUBURB



All measurements are indicative and shown in metres. It is not an exact replica of the property internally or externally. Interested parties should not rely wholly on these plans and make their own enquiries.