





2/28 Jubilee Road Wallsend NSW

2  2  1 

Immaculate and spacious 2 Bedroom, 2 bathroom Villa situated at the front of a superior Boutique complex of 8 with a garden framed by a fragrant Gardenia Hedge. Enter from the tiled covered patio to the central hallway with two spacious bedrooms at the front, the main bedroom complete with a walk-in wardrobe and good sized user friendly ensuite, bedroom 2 with a built-in robe. The main bathroom also incorporates the laundry facilities for convenience.

The generous open plan living/dining and kitchen has the benefit of a 3.4m x 900mm Caesarstone bench with breakfast bar and under bench display cupboard. The modern kitchen also features a gas cooktop, double fridge space and a dishwasher.

The living area connects through sliding glass doors to the private courtyard at the rear for al fresco dining protected in all weather by an Eclipse opening roof to enhance your outdoor experience.

FEATURES INCLUDE:

[For full version visit the website](https://www.crawfordrealestate.com.au)

Type : Villa

Price : \$ 675,000

View : <https://www.crawfordrealestate.com.au/sale/nsw/newcastle-region/wallsend/residential/villa/8191953>



Margaret Jensen
02 4957 6166

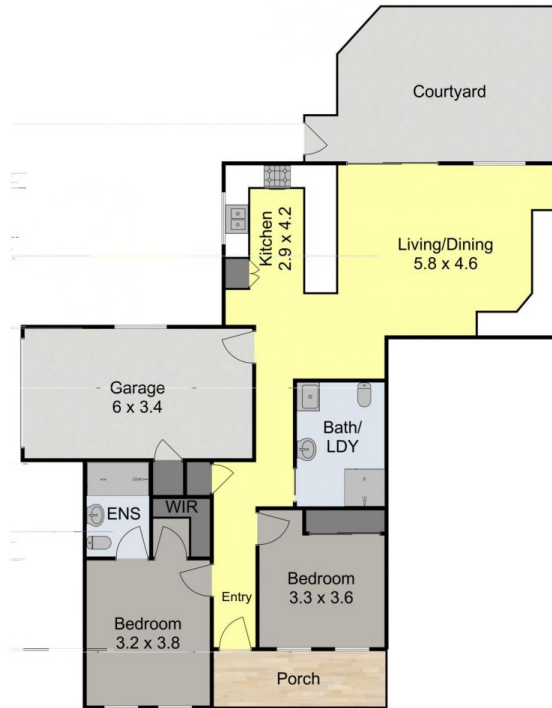

2/28 Jubilee Road,
Wallsend



Measurements are approximate and are to be used as a guide only

